



CAT 408

Classic Advanced, Tweeter

Ø 72mm, 8Ω

SPECIFICATIONS

General Data

Overall Dimensions	DxH	72mm(2.83)x60mm(2.3")
Nominal Power Handling (DIN)	P	120W
Transient Power 10ms		1000W
Sensitivity 1W/1M		89dB SPL
Frequency Response		1,600-25,000 Hz
Cone/Dome Material		Acuflex™ hand coated soft dome
Net Weight	Kg	0.09

Electrical Data

Nominal Impedance	Z	8Ω
DC Resistance	Re	5.2Ω
Voice Coil Inductance @ 1KHz	LBM	0.09mH

Voice Coil and Magnet Parameters

Voice Coil Diameter	DIA	28mm
Voice Coil Height		2.7mm
HE Magnetic Gap Height	HE	2.5mm
Max. Linear Excursion	X	
Voice Coil Former		Aluminum
Voice Coil Wire		Hexatech™ Aluminum
Number Of Layers		2
Magnet System Type		Neodymium vented
B Flux Density	B	
BL Product	BXL	

T-S Parameters

Suspension Compliance	Cms		
Mechanical Q Factor	Qms	0.87	
Electrical Q Factor	Qes	1.3	
Total Q Factor	Qts	0.52	
Mechanical Resistance	Rms		
Moving Mass	Mms	0.46 g	
Eq. Cas Air Load (liters)	VAS		
Resonant Frequency	Fs	780 Hz	
Effective Piston Area	SD	6.0 cm ²	

Features

- * 72mm compact face plate
- * Large Hexatech™ aluminum voice coil
- * Neodymium magnet system
- * Ferro fluid cooled
- * High power handling

Unit Dimensions

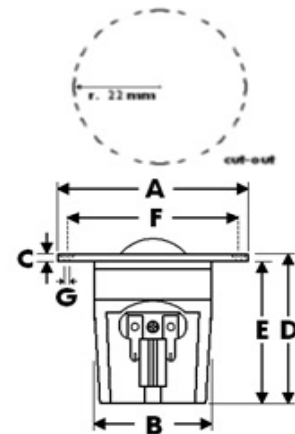

A - Overall diameter	72mm
B - Cut out diameter	44mm
C - Flange thickness	3mm
D - Overall height	60mm
E - Magnet/Chamber depth	57mm
F - Mounting holes location on rim	62mm
G - 3 Mounting holes, at 120° interval,	
inner hole diameter	Ø 3mm
pocket	h 1mm, Ø 7mm

