



C-Quenze 23 I 52 20 06 SD

Resonance frequency - f_s : 33 Hz
 Equivalent volume - V_{as} : 70 liter

Q_{ms} : 1,85
 Q_{es} : 0,3
 Q_{ts} : 0,26

Nominal impedance - Z_n : 8 Ohm
 DC resistance - r_e : 6 Ohm

Effective cone area - S_d : 225 cm²
 Compliance - C_{ms} : 0,988 mm/N
 Mechanical resistance - R_{ms} : 2,64 kg/s
 Moving mass - m_{ms} : 23,5 g
 Inductance 1 KHz - L_e : 0,20 mH
 Force factor - Bl : 9,96 N/A

Winding height - H_c : 20 mm
 Air gap height - H_g : 8 mm
 Nominal power - P_n : 180 W

Acceleration factor: 423
 Efficiency - SPL: 91 dB
 Linear excursion (x-max): 8 mm
 Max. excursion (P-P): 32 mm



Frequency response

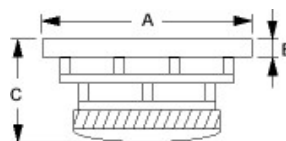
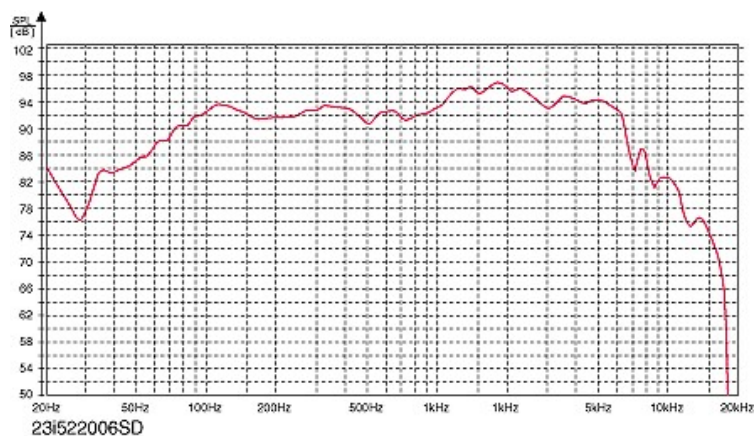



AudioTechnology

Measures on Flexunits

In millimeters

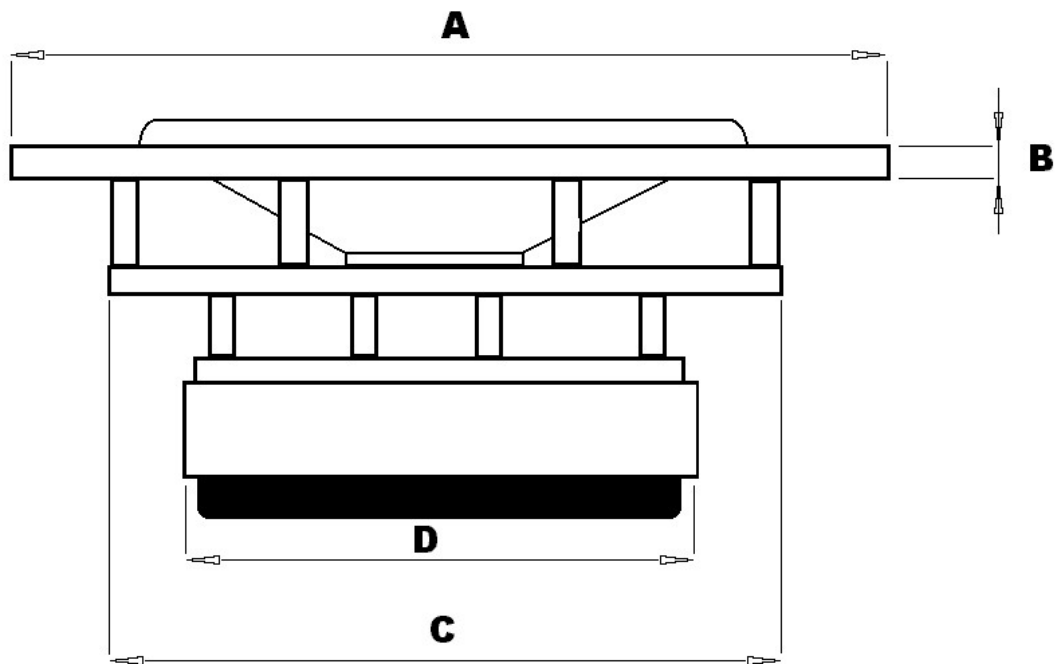

	A	B	C	D	mounting holes
4"	155	8	131	120/110	6 pcs @ Ø 141
5"	180	8	156	131/120/110	6 pcs @ Ø 167
6"	205	8	177	170/131/120/110	6 pcs @ Ø 189
8"	230	8	201	200/170/120/110	8 pcs @ Ø 212
10"	275	10	240	220/200/170	8 pcs @ Ø 258
12"	335	10	297	220/200/170	8 pcs @ Ø 315
15"	410	13	367	220/200	8 pcs @ Ø 393,5

Tolerances on all measures are $\pm 0,5\text{mm}$

C-Quenze

15 H 52:	A = 155 mm	B = 6 mm	C = 131 mm	D = 110 or 120 mm	6 holes Ø 141 mm
18 H 52:	A = 180 mm	B = 6 mm	C = 153 mm	D = 110, 120 or 130 mm	6 holes Ø 167 mm
23 I 52:	A = 230 mm	B = 6 mm	C = 199 mm	D = 130 mm	6 holes Ø 211 mm

